

# perma STAR CONTROL - Quick Start Guide

## 1. Predefine installation / Select lubricant, discharge period + connecting parts

### Examples: Bearing lubrication

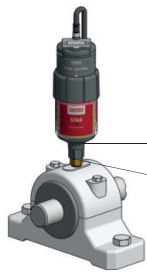

Direct mounting

Support flange  
Reducer

Mounting bracket  
STAR Standard Duty  
1-point G1/4 female  
(109663)

Hose connector 1/4" NPT male  
for hose iØ 3/8" - push-on  
(902160)

Remote mounting for lube-points with vibration,  
limited mounting space, high temperature

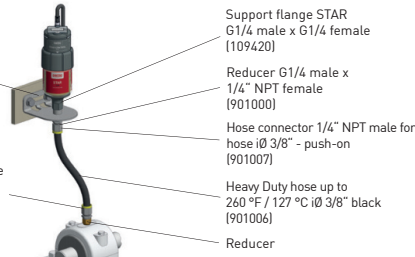

Support flange STAR  
G1/4 male x G1/4 female  
(109420)

Reducer G1/4 male x  
1/4" NPT female  
(901000)

Hose connector 1/4" NPT male for  
hose iØ 3/8" - push-on  
(901007)

Heavy Duty hose up to  
260 °F / 127 °C iØ 3/8" black  
(901006)

Reducer

### Select a suitable lubricant for perma STAR LC unit

Select discharge period  
→ e. g. with perma SELECT APP  
(refer to our product catalog for details)

### Possible mounting positions:



360°

[Oil filled LC  
+/- 45°]

## 2. Prepare lube-point

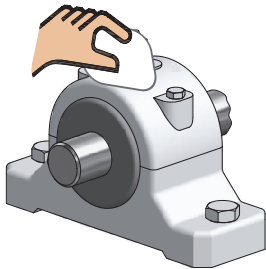

Clean lube-point

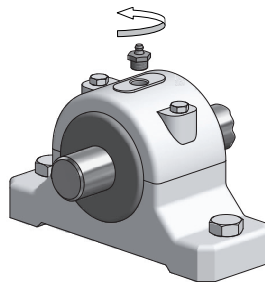

Remove grease fitting

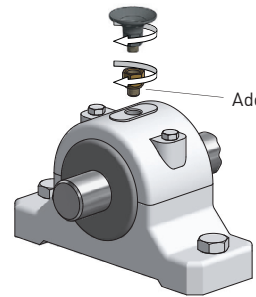

Add sealant

Add reducer, support flange  
and tubes (if required)



For direct mounting:  
Prefill lube-point and any connecting parts  
(use the same grease that is contained in the lubrication system)



For remote mounting:  
Prefill lube-point and any grease lines / connections  
(use the same grease that is contained in the lubrication system)

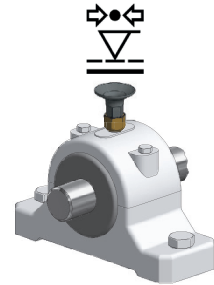

Pressure check: Lube-point / all connecting parts

## 3. Activation / Installation of lubrication system

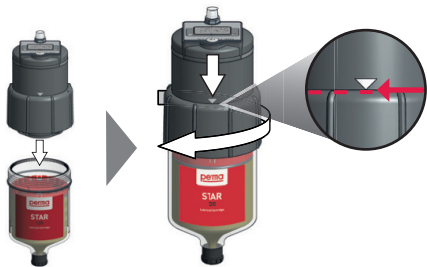

Assemble drive  
and LC

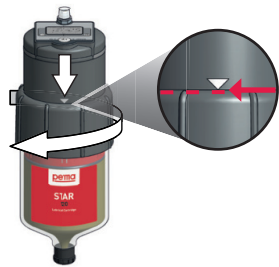

Tighten threaded ring hand tight until  
the white triangle is completely visible



Note activation /  
exchange date  
on label



Configuration can be  
found on the back page



Remove plug



Remove cap and screw  
the lubrication system into  
the lube-point



Connect the cable to the  
drive by screwing it on

## 4. Configuration

Hold down SET button for 5 s; Select desired mode ("TIME" & "IMPULSE") by pressing the SET button

Set the LC size by pressing the SET button (60, 120, 250, 500 cc)

**TIME Mode**

Set the discharge period (1-12 months; 1-26 weeks → only 500 cc)  
Cycle through discharge setting with the SET button

**IMPULSE Mode**

Set the discharge volume (0,1 - 9,5 cc)  
Cycle through volume setting with the SET button

## 5. Electrical connection

**Electrical connection**

|   |     |       |
|---|-----|-------|
| 1 | +   | +V DC |
| 2 | OK  | OK    |
| 3 | GND | GND   |
| 4 | Err | Err   |

9-30 V

**Signal output**

|   |      |     |     |    |
|---|------|-----|-----|----|
| 2 | 1    | 0   | 0   | 1  |
| 4 | 0    | 1   | 0   | 1  |
|   | OK/Δ | Err | Err | LC |

**Connection in parallel**

|   |      |     |        |
|---|------|-----|--------|
| 2 | 1    | 0   | 1      |
| 4 | 0    | 0   | 1      |
|   | OK/Δ | Err | Err/LC |

**HINT** Wiring diagram for 4 perma STAR CONTROL <https://www.permausa.com/en/downloads/quick-start-guides/>

## 6. Quick Reference

| Feature  | Description  |  |
|--|--|--|
| <b>Power supply</b>                                | Power supply is indicated by the plug symbol in the display.   |  |
| <b>Purge</b>                                       | Access the purge feature by holding down the SET button for 10 seconds. Release the button when "PU" appears and the purge will start automatically and show the "PU" LCD display. The green LED will flash. The purge cycle runs for 3 complete discharges of the drive spindle to deliver around 6 cc of grease. It can be stopped at any time by pushing the SET button once. |  |
| <b>LED Light &amp; LCD Screen combinations</b><br> | <b>Normal operation:</b><br>- Green LEDs flash every 7 seconds<br>- LCD screen displays TIME / IMPULSE setting & volume  |  |
|  | <b>Run cycle (lubricant being delivered):</b><br>- Green LED's flash every second<br>- LCD screen displays "ru"  |  |
|  | <b>Empty Lubricant Cartridge (LC):</b><br>- Red LED's double flash every 2 seconds<br>- LCD screen displays "LC"   |  |
|  | <b>Blockage / Back Pressure Overload (OL):</b><br>- Red LED's double flash every 7 seconds<br>- LCD screen displays "OL"   |  |
|  | <b>Purge (PU):</b><br>- Green LED's flash every second<br>- LCD screen displays "PU"   |  |